

16 x 16 Matrix for amomii

Glow

Variations

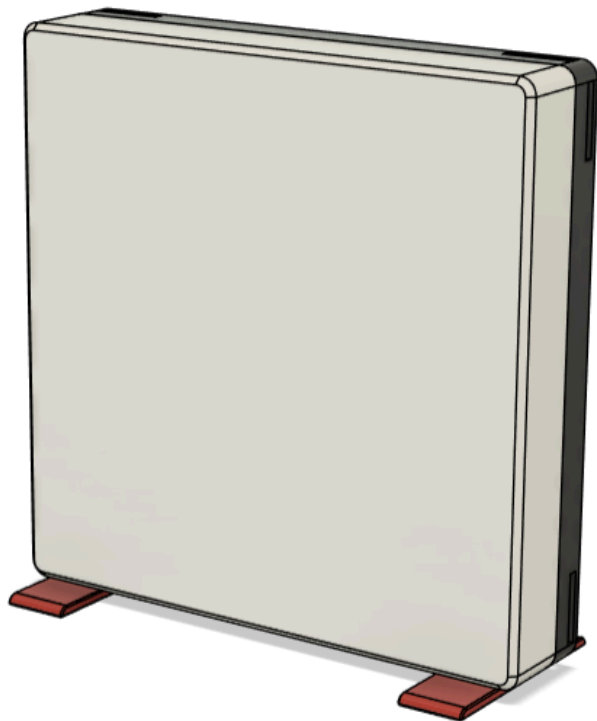

Diffused Pixels

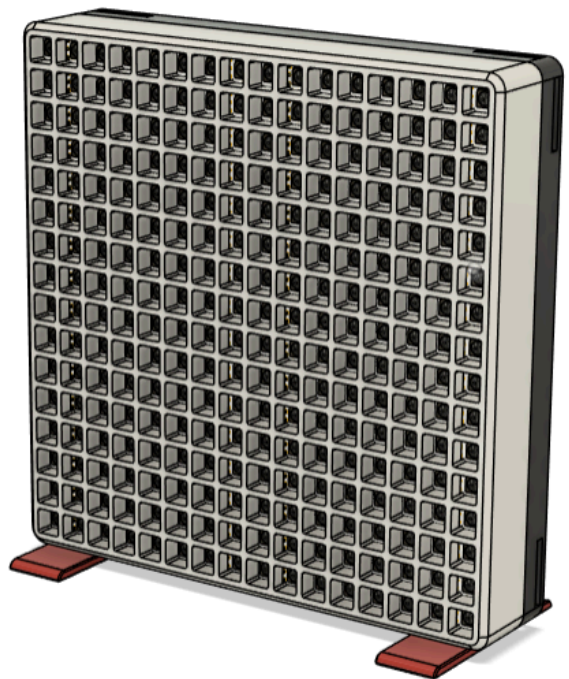

Open Pixels

Exploded View (Using Diffused Pixels Henceforth)

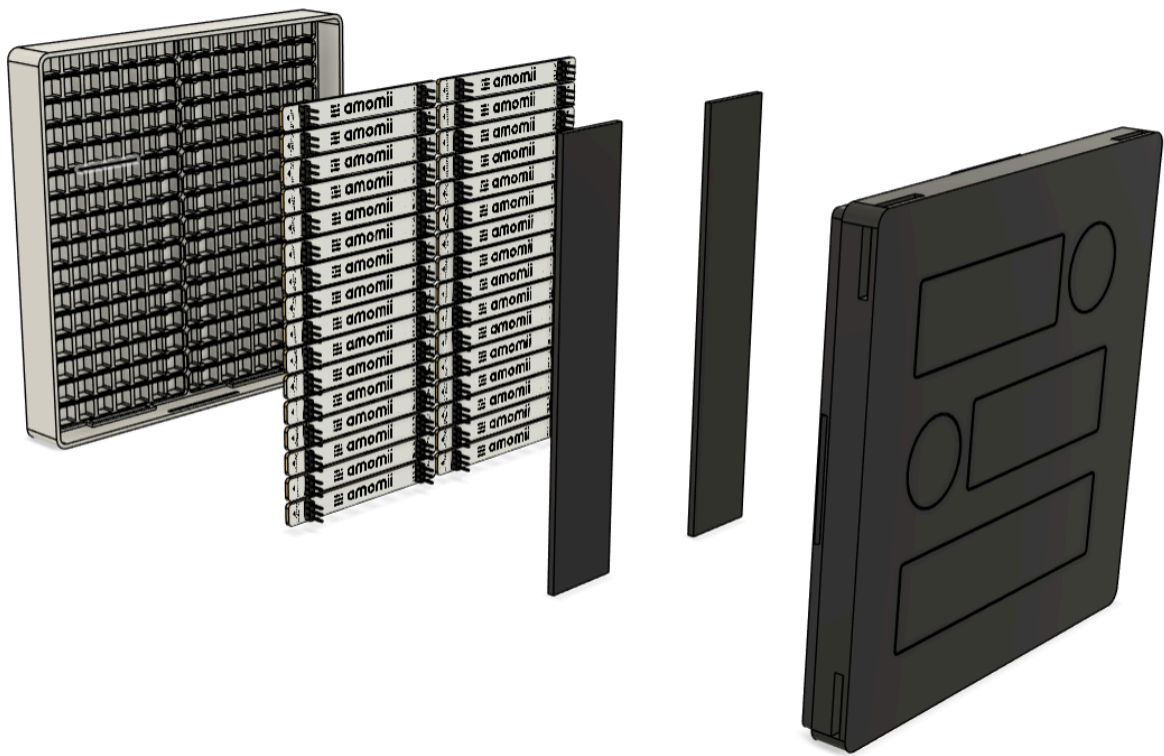

Assembly

Place amomii Glow strips in the grid:

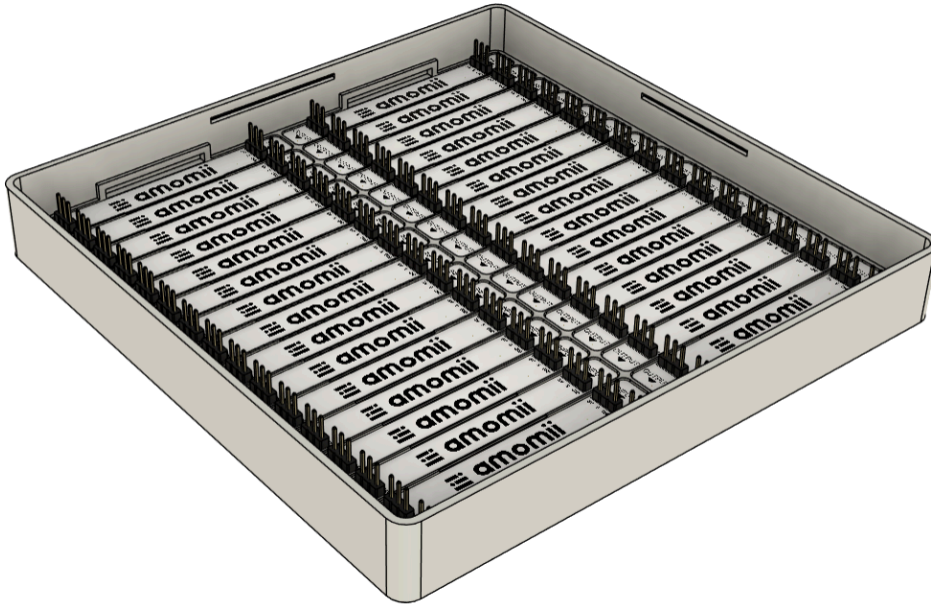

Secure them in place with the holding beams, and wire the amomii Glow strips according to your setup. You will need to bend the beams slightly to insert them into their slots.

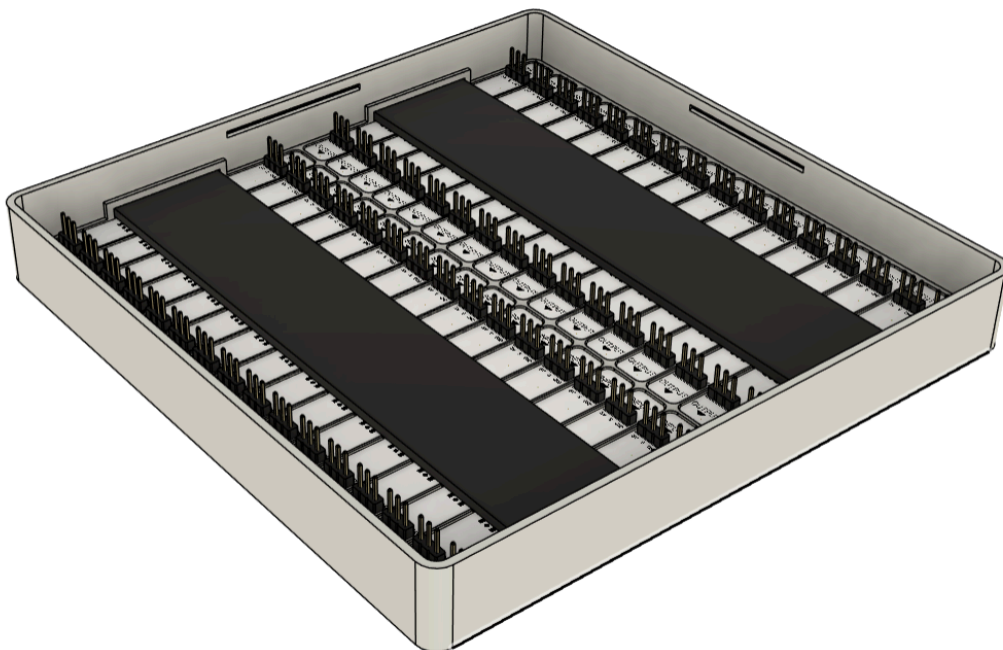

Press the Base into the main case. It should clip in and hold itself firmly without the need for glue.

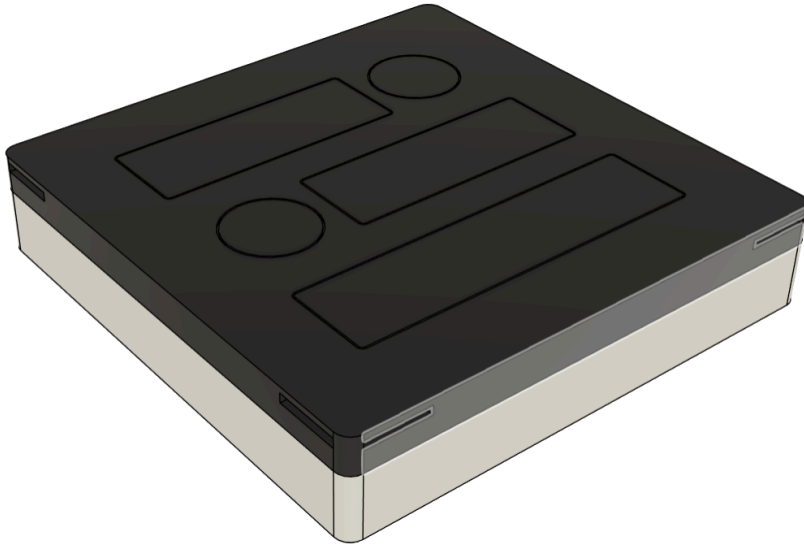

Side Slots

There are 8 slots situated around the corners of the Base. Please note:

1. The slots should print without support (bridge)
2. They can be used as ports for wiring
 - a. Power
 - b. Microcontroller connection
3. They act as air vents
4. They are used connection slots for the Stand and Wall Mounts (more in the next section)



Stand

If you wish to stand your display, you can print two of the Stands and insert them in the two bottom side slots. They should hold themselves in place with friction, but an adhesive could be added if the display is going to be moved around a lot.



Note, for maximum strength, the stands should be printed on their sides.

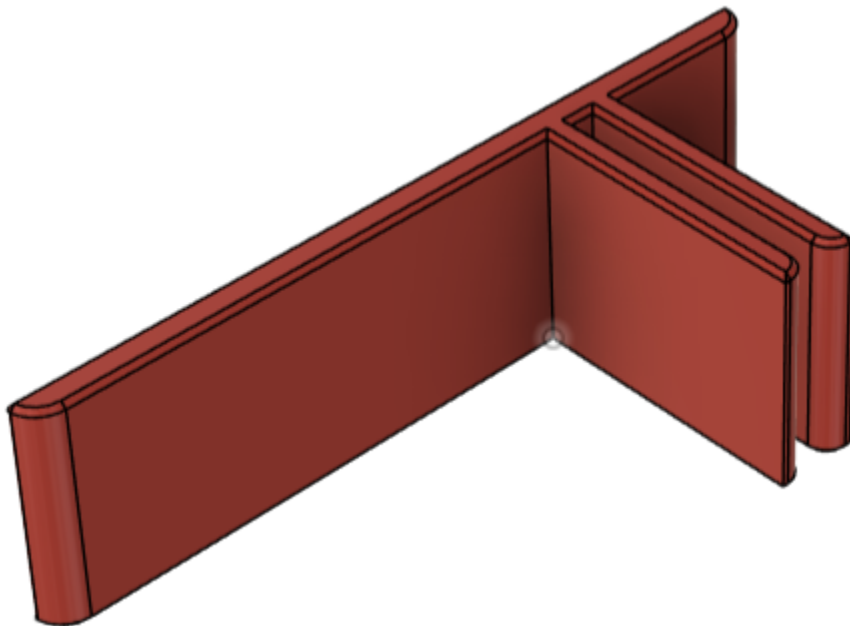

Wall Mounts

If you wish to mount the display to a wall, you can print four Wall Mounts, which insert into the side slots.

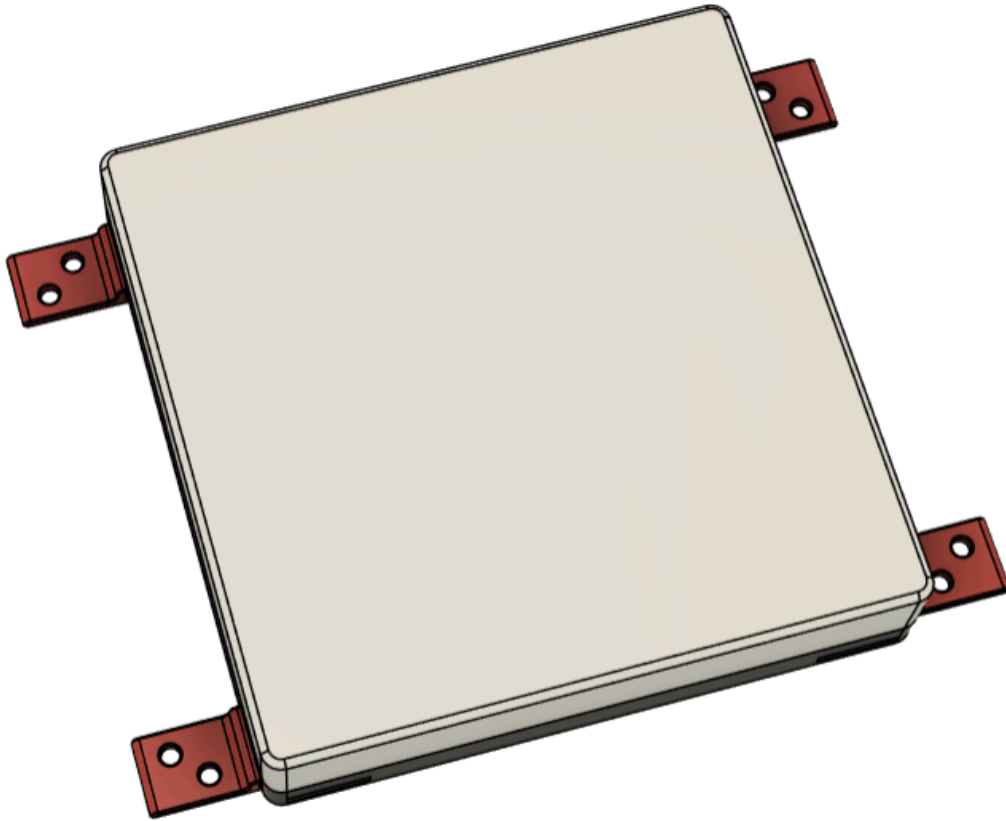

Note, for maximum strength, the mounts should be printed on their sides.

